

NORTON



CG 25 S

OPERATING INTRUCTIONS

CE Declaration of conformity

The undersigned manufacturer:

**SAINT-GOBAIN ABRASIVES S.A.
190, Bd J.F. KENNEDY
L- 4930 BASCHARAGE**

Declares that this product:

Grinding machine: **CG 25 S**

Codes: **70184626882
70184629465**

is in conformity with the following Directives:

- ***European Machinery Directive 2006/42/EC***
- ***Electromagnetic Compatibility Directive 2004/108/EC***
- ***Low Voltage Directive 2006/95/EEC***



Pierre Mersch
Business Manager Machines Europe

Table of Contents

EC Declaration of Conformity	02
1. Introduction	04
2. Machine description	04
Application	
Accessory's	
3. Safety	05
Safety precaution	
Safety regulations	
Safety instructions	
4. Initial operation	07
Checkpoints of electrical safety	
Checkpoints of machine safety	
Removing the diamond disc	
Fixing the diamond disc	
5. Operating	08
Switch on the machine	
Switch off the machine	
Operating during grinding	
6. Maintenance	09
Replacing of the flexible coupling	
7. Technical data	10
Contact	11

1. Introduction

It is important that all persons who are working or maintaining with this machine will read the manual carefully and understand it fully. Keep this manual near to the machine, so it can always be consulted. Only authorized and trained personnel may operate the machine.

2. Machine description

The CG 25 S is an electric driven floor grinding machine for treating horizontal surfaces. The machine has a rotating adapter plate where the diamond or multiflail disc can be fixed on. The rotating parts are covered by a sliding protecting cap with a connection for a dust hose. With a suitable Clipper dust collector you can work without causing dust. The machine can be levelled by turning the height adjustment handle.

Application

The CG 25 S can be used on almost any floor to plane, to make ready for coatings, or to remove coatings or glue residues.

- | | | | |
|---|---------------------------|----|-----------------------------|
| 1 | Height adjustment handle | 6 | Lifting handle |
| 2 | Handgrip | 7 | Coupling |
| 3 | On / Off emergency switch | 8 | Flexible coupling |
| 4 | Dust hose connection | 9 | Adapter plate |
| 5 | Driving motor | 10 | Cutter plate / diamond disc |

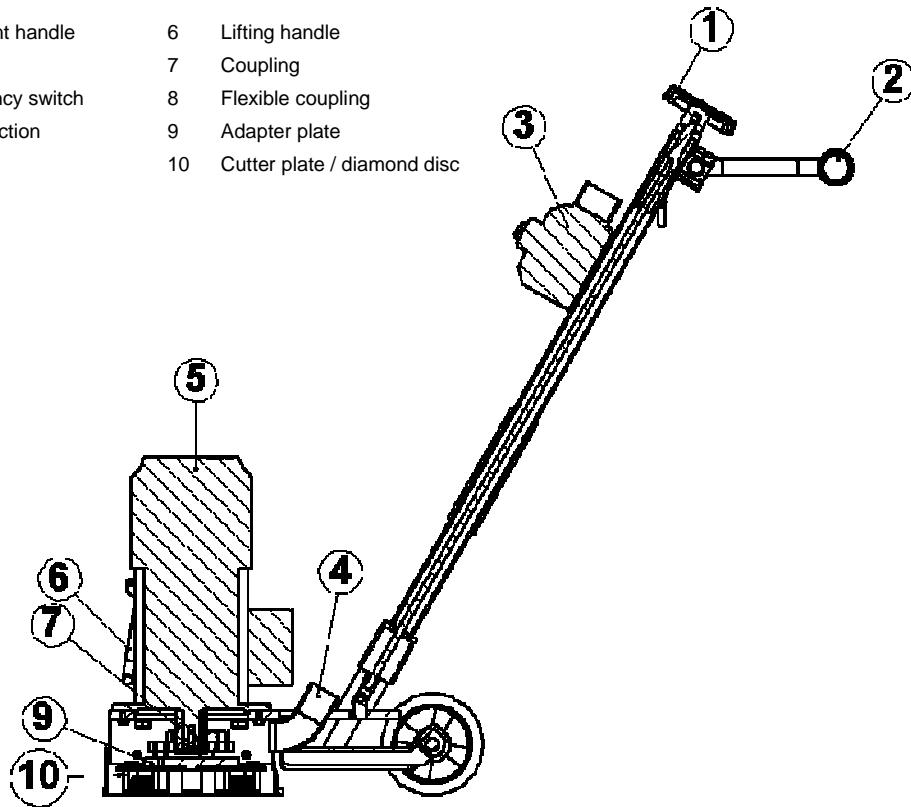

Accessory's

There are several types of discs that may be used on this machine.

The discs that can be used are:

GRD25S	Diamond grinding plate	70184627119
GRM25S	Multiflail rotary disc	70184627120

3. Safety

Before operating the machine, the personnel must be familiar with the safety instructions given in this manual.

Keep this manual near to the machine, so it can always be consulted.

Safety precaution

- The surface to be treated must be swept clean to remove stones, screws etc.
- Never use the machine when the surface is not clear and if there is a risk of tripping.
- Make sure there is not any water on the surface to be treated
- Remove any trailing electrical cables and or dust hoses from the surface to be treated
- Always use a dust collector.
- Don't get disturbed during the activities.

Safety regulations

- Persons who are not operating the machine must not be permitted to stay in the surrounding area of the machine.
- Don't change anything on the machine. Use always cables which are approved and safety earthed (extend) cables. The machine is always equipped with an earthed connection, do not change this and use always earthed cables with an earthed plug.
- Connect main power supply cable to an installation with an earth leakage circuit breaker.
- Inspect and test the electrical components regularly. The electrical components have to satisfy to the requirements which apply to these components.
- Always call a skilled electrician when you have questions about the safety of the electrical components.
- Work on electrical equipment or operating materials may only be undertaken by a skilled electrician or by trained persons under the guidance and supervision of a skilled electrician as well as in accordance with the electrical engineering regulations.
- Pull out the main plug during inspections and repairing on the machine.
- Never operate the machine when the surface is wet.
- Never use the machine in the rain.
- The machine contains rotating parts which are covered by a sliding protection cap. At times of a rotating motor, the protection cap must be always in contact with the floor.
- The flexible coupling can become obsolete with use, because of this there can be higher vibrations than normal. Check for this reason regularly the flexible coupling.

The following sticker is placed on the machine.



Meanings of these symbols are:

- Ear protection is obliged.
- Safety glasses with lateral protection are obliged.
- CE-mark on this machine
- Safety shoes obliged
- Consult the manual before operating the machine.

Personnel must tie back long hair and not wear loose clothing or jewellery including rings.
Wear gloves and dust mask during operating the machine.

Safety instructions

- Do not stand the machine on the diamond disc or coupling when it is not in use, this will cause deformation to the flexible coupling. Lay down the machine on the handle.
- Make sure the machine is clean and that the handgrips are dry and free of grease and oil.
- Pull out the main plug when changing the disc or flexible coupling.
- The CG 25 S weights 70 kilogram. It is not allowed to lift this machine with 2 persons. Use preferably appropriate appliances as a lift or crane.
- Lift the machine up by the points 1 and 2.

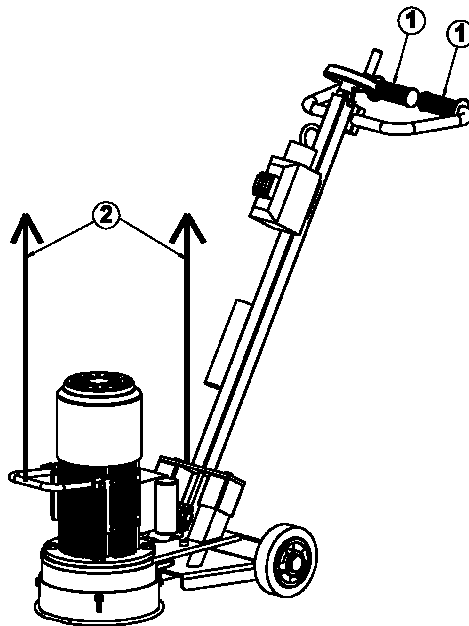

4. Initial operation

Before using the machine it is committed to inspect the machine.

It is not permitted to use the machine if the machine safety is not according the checkpoints below.

Checkpoints of electrical safety

- Use only extension cables for extending the main cable that are sized and marked in accordance with the overall power consumption of the machine.
- Electrical cables must be rolled entirely off of the reels.
- Any damage to electric cables is not permitted.
- Use an electrical power supply connection with earth connection.

Checkpoints of machine safety

Check if:

- The safety functions and operating functions work correct.
- The flexible coupling is not deformed or damaged.
- The diamond / multiflail disc is not damaged
- The protection cap is fixed properly and slides well.
- There are not any loose nuts or bolts.
- There is no damage to the dust hose and if it is connected well.

Removing the diamond disc

- Make sure the power supply plug is pulled out of the machine.
- Lay down the machine so it is lying on the handle. Make sure the machine will not fall back down. A second person can stands on the handle to make sure it will not fall back down.
- Loosen the 4 bolts with an appropriate key.
- Remove the diamond or multiflail disc

Fixing the diamond disc

- Make sure the power supply plug is pulled out of the machine.
- Lay down the machine so it is lying on the handle. Make sure the machine will not fall back down. A second person can stands on the handle to make sure it will not fall back down.
- Fix the diamond or multiflail disc underneath the adapter plate and turn on the 4 bolts with an appropriate key.

5. Operating

During operating the CG 25 S the following additional safety instructions must be followed closely.

Switch on the machine

- Level the machine with the height adjustment handle
- Turn on the dust collector before switching on the machine.
- Connect the power cable to the machine
- Stand behind the machine
- Push down on the handle of the machine so that the diamond disc is off of the ground, but the protection cap stays in contact with the floor.
- Push the green button on the electrical box.
- Let down the machine till the diamond disc hits the floor.
- Start grinding.

Switch off the machine

- Push the red button on the electrical box.
- Wait until the machine stops rotating before laying down the machine on the handle.
- Pull out the power supply cable of the machine.
- Turn of the dust collector.

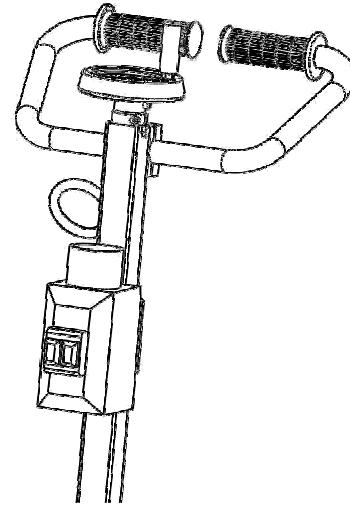

Operating during grinding

To get an optimum result during grinding, the machine must not stand still. The machine must always be in movement so it does not grind too deep into the floor. Move the machine from left to right and from forward to backwards to get a nice flat result.

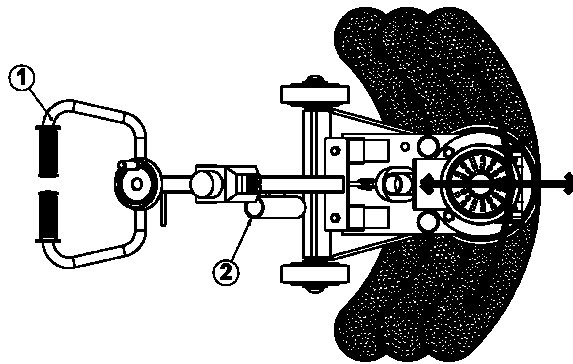

6. Maintenance

Work only with original Norton and Clipper parts.

Check regularly to see if the diamond disc is in good condition. Replace immediately the diamond disc when this is damaged or worn out.

Check if the flexible coupling is stiff enough, after every 2 diamond disc changes. Replace if any deformation or damage is found, replace the coupling after use of 7 diamond discs. Unusual vibrations on the machine check immediately the diamond disc and flexible coupling.

Replacing of the flexible coupling:

- Pull out the main plug
- Remove the diamond disc
- Remove the protection cap
- Loose the bolts of the adapter plate and the flexible coupling
- Take a new flexible coupling and assemble this together with the adapter plate on the fixed coupling on the motor axle.
- Assemble the protection cap

Prevent premature wear by keeping the machine as dust free as possible. Clean the machine for this reason regularly with a dust collector.

Clean the machine every day with air and non-aggressive materials. Never use a high pressure water cleaner to clean the machine.

Remove the diamond disc after using the machine.

Store the cleaned and dry machine in a dry and humid free room. Protect the electrical motor from moisture, heat, dust and shocks.

All repair work must to be done by qualified Saint-Gobain Abrasives personnel, this to guarantee a safe and reliable machine.

Any guarantee on the machine is expired when:

- Non original Norton and Clipper parts and diamond discs have been used.
- Repair work is not done by qualified Saint-Gobain Abrasives personnel
- Changes, add on's or conversions are undertaken without written permission of Saint-Gobain Abrasives.

7. Technical data

	CG 25 S 230V 70184656882	CG 25 S 110V 70184629465f
Power consumption	2,2 kW	1,2 kW
Electrical connection	230V / 50 Hz	110V / 50 Hz
Diameter diamond disc	Ø 250 mm	Ø 250 mm
Working width	250 mm	250 mm
Rotation speed	1440 min ⁻¹	800 min ⁻¹
Length	1180 mm	1180 mm
Width	520 mm	520 mm
Height	1120 mm	1120 mm
Weight	70 kg	70 kg
Noise level	80dB(A)	80dB(A)
Dust hose connection	51 mm Ø	51 mm Ø
Suitable filter unit	Contact Clipper we will assist you with a good advice.	Contact Clipper we will assist you with a good advice.

Design and specifications are subject to change without notice by Saint-Gobain Abrasives.

Guarantee can be claimed and technical support obtained from your local distributor where machines, spare parts and consumables can be ordered as well:

Benelux and France:

From Saint-Gobain Abrasives
in the Grand-Duché de Luxembourg
Free telephone numbers:
Belgium : 0 800 18951
France: 0 800 90 69 03
Holland: 0 8000 22 02 70
e-mail: sales.nlx@saint-gobain.com

Germany

Saint-Gobain Diamond Products GmbH
Birkenweg 45-49,
D-50389 WESSELING
Tel : (02236) 8911 0
Fax : (02236) 8911 30
e-mail: sales.ngg@saint-gobain.com

Spain

Saint-Gobain Abrasivos S.A.
C/. Verneda del Congost s/n
Pol.Ind. El Pedregar
E-08160 MONTMELÓ (Barcelona)
Tel: 0034 935 68 68 70
Fax: 0034 935 68 67 14
e-mail: Comercial.sga-apa@saint-gobain.com

Hungary

Saint-Gobain Abrasives KFT.
Banyaleg Utca 60B
H-1225 BUDAPEST
Tel: ++36 1 371 2250
Fax: ++36 1 371 2255
e-mail: nortonbp@axelero.hu

Czech Republic

Norton Diamantove Nastroje Sro
Vinohrdadska 184
CS-13000 PRAHA 3
Tel: 0042 0267 13 20 21
Fax: 0042 0267 13 20 21
e-mail: norton.diamonds@komerce.cz

United Kingdom

Saint-Gobain Abrasives Ltd.
Doxey Road
Stafford
ST16 1EA
Tel : 0845 602 6222
Free fax : 0800 622 385
e-mail : nortondiamonduk@saint-gobain.com

Italy

Saint-Gobain Abrasivi S.p.A.
Via per Cesano Boscone, 4
I-20094 CORSICO-MILANO
Tel: 0039 02 44 851
Fax: 0039 0245 101238
e-mail: Norton.edilizia@saint-gobain.com

Austria

Saint-Gobain Abrasives GmbH
Telsenberggasse 37,
A-5020 SALZBURG
Tel: 0043 662 43 00 76 77
Fax: 0043 662 43 01 75
e-mail: office@sga.net

Poland

Saint-Gobain Diamond Products Sp.zO.O.
AL. Krakowska 110/114
PL-00-971 WARSZAWA
Tel: 0048 22 868 29 36
Tel/Fax: 0048 22 868 29 27
e-mail: norton-diamond@wp.pl



SAINT-GOBAIN ABRASIVES

190, Bd John F. Kennedy
L-4930 BASCHARAGE
LUXEMBOURG

Tel.: ++352 50 401-1

Fax: ++352 50 16 33

e-mail: sales.nlx@saint-gobain.com

www.construction.norton.eu

05.08.2009