

HILTI

Hilti PX 10
transponder



Point through floors and walls.

Hilti. Outperform. Outlast.

Applications

- Finding the drill bit exit point or transferring the starting point before drilling through-holes in floors or walls with diamond coring equipment or rotary hammer drills on concrete or masonry
- Wall thickness measurement for easy selection of the required drill or core bit length and drilling angle

Advantages

- Allows drilling to be carried out quickly and efficiently
- No need for time-consuming procedures such as drilling pilot holes, measuring out manually or “trial and error”
- Overhead drilling becomes unnecessary
- Positions can be transposed through floors and walls
- Direction arrows for easy, user-friendly operation

Highlights

- Employs the magnetic field detection principle to bring the receiver into alignment with the transmitter
- The unique slope adapter allows the drill bit exit point or starting point to be determined for a given angle or, alternatively, the required drilling angle to be determined for a given exit point and starting point

Through floors and walls. Reliable through-holes thanks to magnetic field detection.

Ruggedly-built positioning tool that locates the drill bit exit point or starting point before drilling through concrete or masonry.

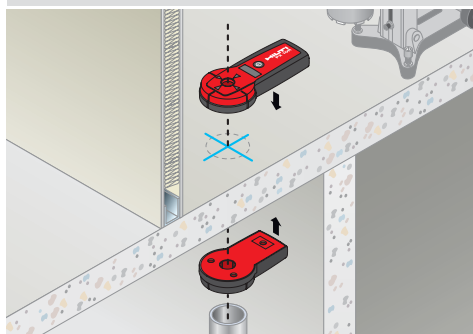

Allows free choice of drilling direction, for example when drilling through floors or before tricky coring operations.

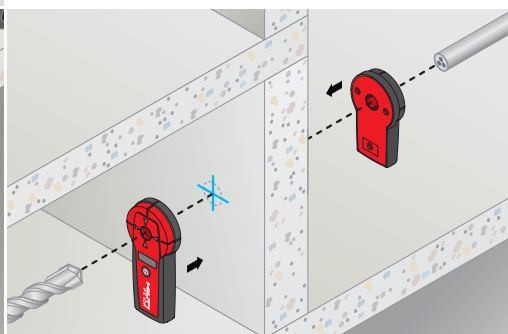

Drilling positions can be marked even where floor levels differ or dividing walls are not in line.

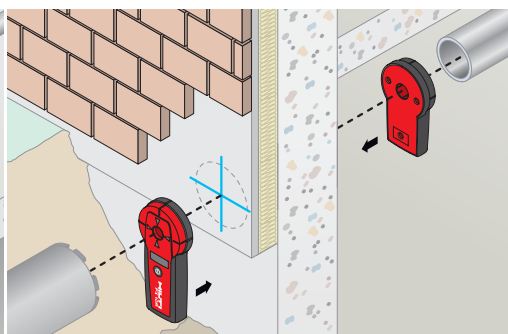

When drilling through insulation or cladding, for example, damage can be avoided by drilling in the right direction.



It's so easy.

1. Mark the position where the hole is required (exit or entry point).
2. Use adhesive putty to attach the transmitter to the surface at this position.
3. Locate the signal on the opposite side of the wall or floor with the receiver. The position has been found when all direction arrows light simultaneously.
4. Mark the spot where the hole is to be drilled, read the thickness of the wall or floor from the display and select a suitable drill or core bit.

Reliable accuracy.

To ensure reliability in accordance with standards and statutory requirements, Hilti recommends that detection tools are checked regularly as part of the Hilti Calibration Service. The Calibration Certificate confirms that the tool is in compliance with specifications.



HILTI

2 Years

LIFETIME SERVICE

NO COSTS

Lifetime

Lifetime

REPAIR COST LIMIT

MANUFACTURERS WARRANTY

The unique, comprehensive service for all Hilti tools – for the entire life of the product.

Performance data

Range	5 cm – 1.35 m	
Positioning accuracy*	± 2 mm / 200 mm wall thickness	
Thickness measurement accuracy*	± 5% of wall thickness	
Power source / battery life	9 V battery in each device / approx. 17 hours	
	PX 10T transmitter	PX 10R receiver
Dimensions, L×W×H (mm)	160×95×33	210×95×33
Weight with battery	240 g	275 g

* Accuracy may be significantly reduced by irregularly positioned reinforcing bars, welded reinforcing mesh, sheet metal or other metal objects close to the tool. Please refer to the operating instructions for a detailed list of technical data.

Transpointer

Ordering designation	Item no.
PX 10 transpointer	273124
PX 10T transmitter, PX 10R receiver, two PDA 60 hand straps, PUA 91 adhesive putty, PUA 92 adhesive strips, two 9 V alkaline batteries, PX 10 operating instructions, two producer certificates, packed in an impact-resistant plastic Hilti case	
PX 10 transpointer set	273126
PX 10T transmitter, PX 10R receiver, two PDA 60 hand straps, PUA 91 adhesive putty, PUA 92 adhesive strips, two 9 V alkaline batteries, PX 10 operating instructions, PUA 70 marker, PXA 70 slope adapter, two producer certificates, packed in an impact-resistant plastic Hilti case	



Accessories and consumables

Ordering designation	Item no.
PXA 70 slope adapter	① 273130
PDA 60 hand strap	② 282389
PUA 70 marker, pack of 12	③ 340806
PUA 91 adhesive putty	④ 273131
PUA 92 adhesive strips, pack of 50	⑤ 273132



Productivity plus



Laser tools for easy, accurate measurement, leveling and alignment



Powerful combihammers for tough drilling and chiseling jobs



User-friendly, cost-efficient diamond coring machines featuring compact design and advanced technology



Drill bits perfectly matched to Hilti tools for maximum performance and productivity

Hilti. Outperform. Outlast.

Hilti Corporation | 9494 Schaan | Liechtenstein | P +423-234 2111 | F +423-234 2965 | www.hilti.com