



MSA ENGINEERING SYSTEMS LIMITED

# **NEXUS 500 Series Electrofusion Control Unit**

## ***Operating Manual*** ***2008 - Revision A***



---

The information contained in this manual is consistent with MSA's knowledge at the time of publication. Any unauthorised usage of this equipment other than that to which it was designed will negate any liability unless specifically authorised in writing by MSA Engineering Systems Limited. This does not affect statutory rights.

## **Contents**

	<b>Page No.</b>
<b>1.0 Equipment Required</b>	<b>1</b>
<b>2.0 Equipment List</b>	<b>1</b>
<b>3.0 Warranty</b>	<b>1</b>
<b>4.0 Safety and Care</b>	<b>1</b>
4.1 General Safety	1
4.2 Electrical Safety	2
4.3 Equipment Care	2
<b>5.0 Specifications</b>	<b>3</b>
<b>6.0 Introduction</b>	<b>4</b>
6.1 Description	4
6.2 Control Layout	4
6.3 Preliminary Checks Before Operation	5
<b>7.0 Operation</b>	<b>6</b>
<b>8.0 Additional Screens</b>	<b>19</b>
<b>9.0 Maintenance</b>	<b>22</b>
9.1 Spare Parts	22
9.2 Testing	22
9.3 Service	22
<b>10.0 Appendix One – Models and Accessories</b>	<b>23</b>
10.1 NEXUS Models	23
10.2 Accessories	23

### **1.0 Equipment Required**

To successfully join polymer pipes using electrofusion couplers you will need the following equipment:

1. An MSA NEXUS 500 Series Electrofusion Control Unit
2. A TIN-12 certified generator (110/220Vac, depending on ECU) with a 3.5kw minimum output
3. A set of electrofusion clamps
4. Tools for de-burring and scraping the pipeline
5. Approved couplings

### **2.0 Equipment List**

Equipment included in the basic package includes:

- MSA NEXUS 500 Series Electrofusion Control Unit
- Nexus Remote Keypad hand held unit (HHU)
- 4.0mm and 4.7mm Terminal Ends
- Operating Manual
- Calibration Certificate

For a list of available accessories, see section 10.2

### **3.0 Warranty**

MSA NEXUS Electrofusion Control Units are guaranteed against faulty materials or workmanship for a period of 12 months from the date of purchase. Any units which fail under the warranty will be repaired or replaced free of charge at the discretion of MSA Engineering Systems Limited.

### **4.0 Safety and Care**

#### **4.1 General Safety**

Most welding tasks may be considered as hot work in site situations and may be subject to specific permits to work.

This equipment should only be used by an operator who has been deemed competent to do so by his/her employer.

This equipment should be used by an able bodied, competent adult who has read and understood the operating instructions. Anyone with either a temporary or permanent disability should seek expert advice before using it.

Keep children, animals and bystanders away from the work area. Cordon off a NO GO area using cones and either barriers or tape.

## **NEXUS 500 Series Electrofusion Controller**

**WARNING : If you are wearing an electronic life support device (a heart Pacemaker) you must consult your doctor before going near or working with the equipment. Magnetic fields associated with high currents may affect these devices.**

Never use this equipment if you are ill, feeling tired, or under the influence of alcohol or drugs.

Wear practical, protective clothing, gloves and footwear.

Always switch OFF the equipment when not in use.

Never use welding equipment near computers or any sensitive electronic equipment.

This equipment is designed to be within the lifting allowance of an able bodied male.

Ensure the work area is well lit and ventilated.

Make sure you know how to switch this machine OFF before you switch it on, in case you get into difficulty.

Check the condition of the equipment before use. If it shows signs of excessive wear or damage, contact your supplier.

### **4.2 Electrical Safety**

If the equipment fails, or any of it's cables or plugs become damaged, return it. Never try to repair it yourself.

Keep cables out of harm's way and clear of the work area.

All leads should be fully unwound, loosely coiled and suspended from the handle utilising the strap provided when storing or transporting the unit (see picture to the right). Never run them through water, over sharp edges, or where they could trip someone.

This equipment is IP65 rated, but please bear in mind that using electrical equipment in very damp or wet conditions can be dangerous.



### **4.3 Equipment Care**

Never push the equipment beyond its design limits. Check the technical specification to ensure you are using the correct equipment. When not in use, store the equipment somewhere clean, dry and safe. Keep the equipment clean. It is recommended to clean the unit with a dry cloth.

## 5.0 Specifications

Input Voltage:	110V Unit ▶ 90Vac to 130Vac, 40 – 75 Hz 220V Unit ▶ 190Vac to 260Vac, 40 – 75 Hz
Input Current:	32A (Maximum) On 110V unit 16A (Maximum) On 220V unit
Output Power:	3.5kVA maximum
Output Voltage:	8 – 48Vac <sub>RMS</sub> ± 0.5Vac <sub>RMS</sub>
Output Current:	100A (Maximum)
Duty Cycle, t <sub>d</sub> :	t <sub>d</sub> = 30 minutes Full Load at 40°C or 5 cycles of 10 minutes ON and 10 minutes OFF
Operating Temperature:	-10°C to +50°C
Fusion Capability:	Diameter range 20 – 315mm (NOTE: can weld greater than 315mm subject to meeting conditions for duty-cycle and output characteristics).
ECU:	500(W) x 180(D) x 330(H) mm – <i>approximate overall dimensions</i>
Remote Keypad	116(W) x 220(D) x 119(H) mm – <i>approximate overall dimensions</i>
Remote Keypad Cable:	3 metres (Remote Keypad detachable)
Input Supply Cable:	3 metres – STANDARD
Output Welding Cable:	3 metres – STANDARD / 6 metres for COMBI units
Net weight – ECU:	17.8kg (110V) and 19.3Kg (220V)
Net weight - remote keypad:	0.6kg
Fusion Timer:	1 – 899 time in seconds, 901 – 999 time as 1 – 99 minutes preceded by the digit "9" (Limited by welding transformer capability)
Input Protection:	35A Circuit Breaker reset externally
Seal Rating:	Control Unit ▶ IP65
Display:	Remote Keypad ▶ LCD 20characters x 4lines, LED back-lit
Data Entry:	16 Keys Alpha-numeric system
Operating Modes:	Weld 39.5V, Weld 8-48V and Auto (Barcode)
Temperature compensation:	Yes – in Barcode mode
Memory Storage:	2048 Joints
Additional Features:	Data retrieval to serial RS232 PC download Temperature compensation in Barcode mode Fusion status buzzer indication Welding voltage display Welding current display Input voltage display Ambient temperature display User friendly

### NEXUS 500 series ECU classification according to ISO 12176:

Classification Number: **P<sub>2</sub>3US<sub>2</sub>VKADX**

P <sub>2</sub>	Low voltage input – 110V / 240V (AC)
3	Output power maximum – 3kW
U	Regulation mode – Voltage
S <sub>2</sub>	Very low output voltage – 8V to 48V (RMS)
V	Control unit type – Variable
KA	Data introduction – Manual and Automatic
D	Equipped with data retrieval system
X	Polyvalent and Multi-mode – capable of welding wide range of electrofusion fittings from different manufacturers

## 6.0 Introduction

### 6.1 Description

The NEXUS has been designed to be extremely versatile, able to accommodate all 8 to 48 Volt fittings currently manufactured within the specifications of the device.

The NEXUS aims to supply a constant output voltage. The output is, in addition, timed to guarantee an identical faultless joint every time. The control unit also monitors it's own functions as well as the power inlet and outlet, and prompts the user if any parameters fall outside pre-determined limits.

User interface is via a Remote Keypad (HHU - Hand Held Unit), featuring an alphanumeric keypad and a 4-line, 20-digit backlit LCD display. The microprocessor generated prompts and messages instruct and offer information, which do not require a reference table or guide sheets. The digital display indicates the fusion time selected and, during a fusion cycle, the time left to run.

### 6.2 Control Layout

1. HHU ON/OFF, E-STOP button
2. 4-line, 20 character, alphanumeric, backlit LCD screen
3. Alpha-numeric keys (x10)
4. Arrow keys (x4)
5. STOP Button
6. MENU Button
7. ENTER Button
8. START Button

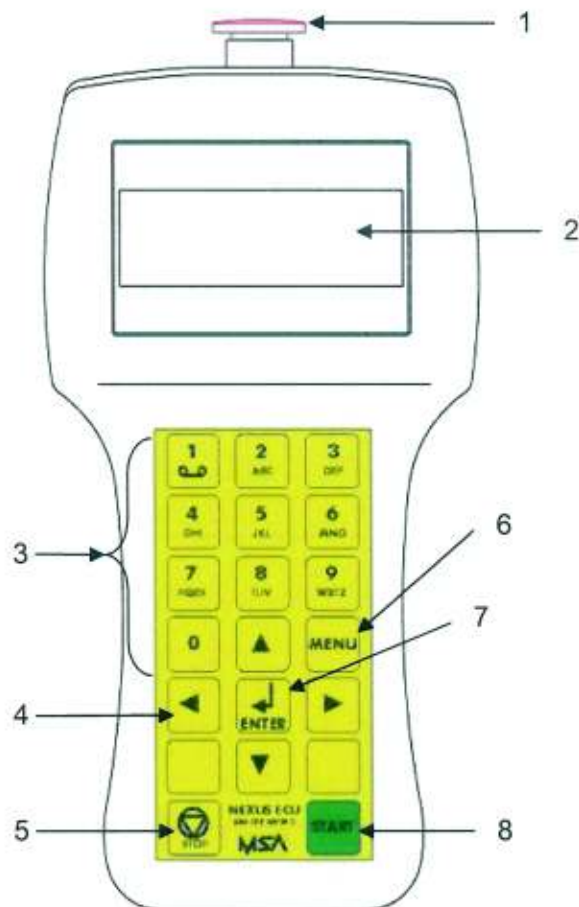

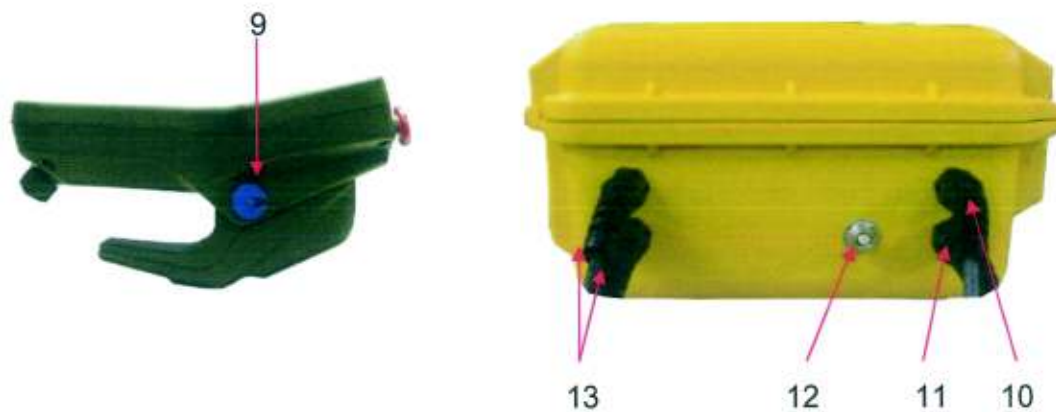

- 9. RS232 serial port for barcode scanner and PC data download
- 10. Remote Keypad lead
- 11. Input lead
- 12. Circuit breaker (2 breakers fitted for 110V unit)
- 13. Output leads

### 6.3 Preliminary Checks Before Operation

Refer to Control layout (section 6.2) above.

- 1. To turn unit ON/OFF use button (1).
- 2. Check RCD breaker (10) is switched on.
- 3. Check RCD window (10) is not damaged and is secured to protect seal rating of IP65, i.e. thumbscrew is fully fastened.
- 4. Check Circuit breaker (13) is pushed-in, i.e. not tripped.
- 5. Check RS232 port (8) dust cover is secured all the time when not in use to protect seal rating of IP65.

## 7.0 Operation

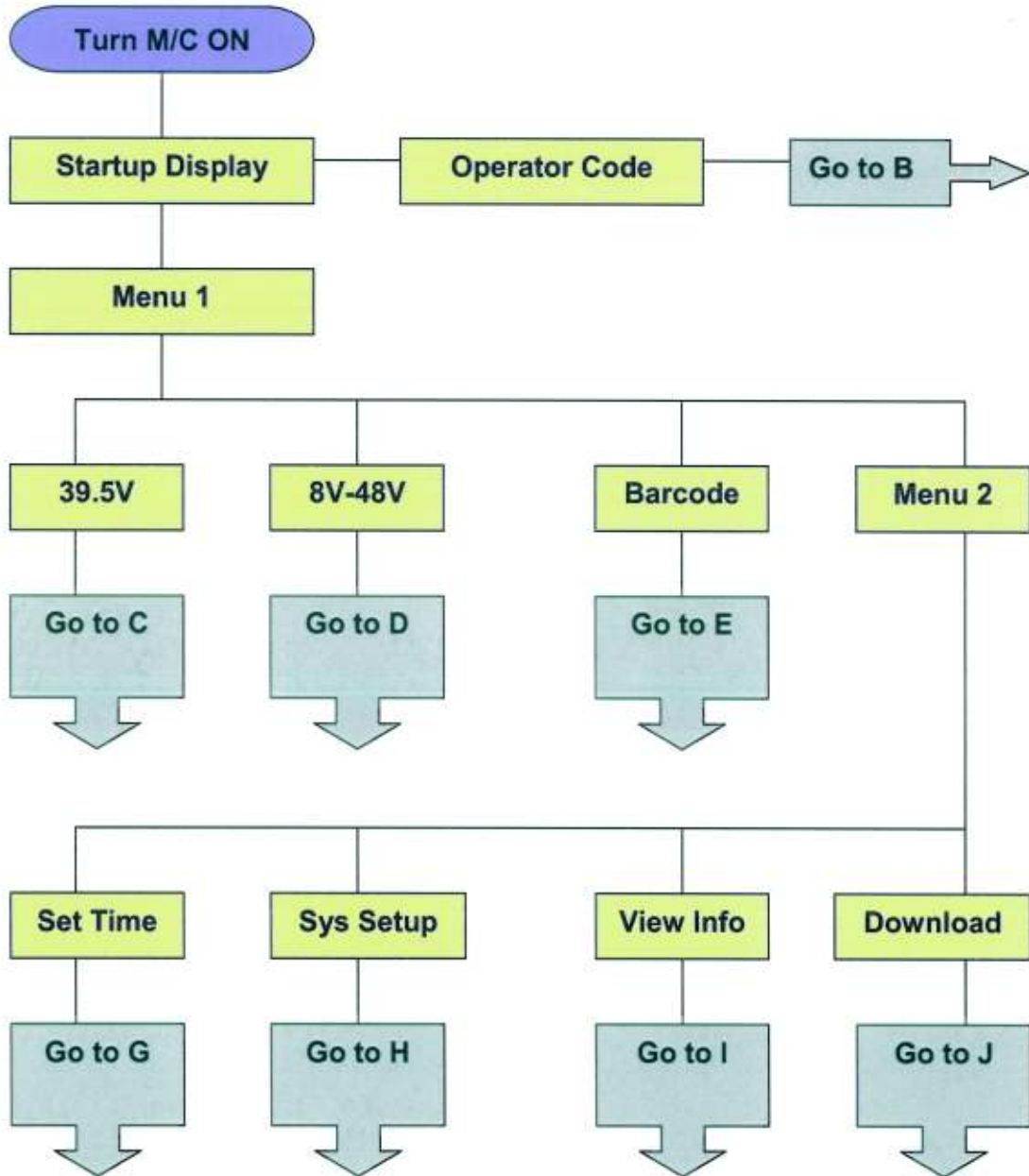





MSA ENG. SYSTEMS LTD  
NEX510-BD-220-LT  
V08-01-02  
S/N: 2001

OPERATOR CODE  
6 DIGITS: MSA123  
Press ENTER  
RIGHT, LEFT, STOP=CLR

This screen  
can be turned  
on/off from  
Menu 2

MENU1: 1=39.5V  
2=8V-48V  
3=BARCODE  
4=MENU2

Operator code:

This screen prompts the user for a 6-digit Operator Code, used as identification for the user. This code is entered with the following sequence:

Use alphanumeric keypad to enter desired characters.

Use RIGHT\_ARROW key to advance cursor position to right (next character).

Use LEFT\_ARROW key to backspace cursor position to left (previous character).

Use KEY\_STOP to clear all characters and start again.

Use KEY\_ENTER to accept and save code.

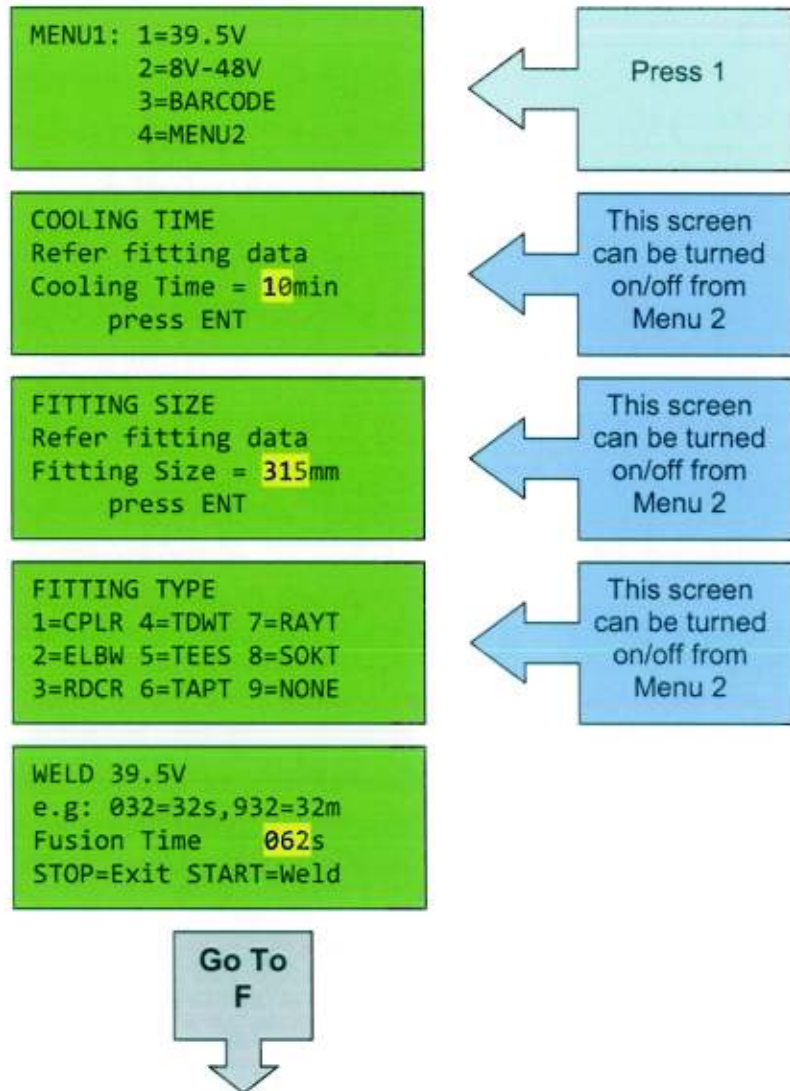

WELD 39.5V:

The following screens can be turned ON/OFF from Menu 2 (refer to Menu 2 section for details):

- COOLING TIME – enter required cooling time as specified in the fitting’s data. Unit will go into countdown mode after a weld for the duration of cooling time entered. This information will be displayed in data retrieval.
- FITTING SIZE – this information is stored for data retrieval purpose only.
- FITTING TYPE – this information is stored for data retrieval purpose only. Refer below for more details on abbreviations.

## **NEXUS 500 Series Electrofusion Controller**

---

CPLR = COUPLER  
ELBW = ELBOW  
RDCR = REDUCER  
TDWT = TDW TAPPING TEE  
TEES = TEES  
TAPT = TAPPING TEE  
RAYT = RAYTRANS  
SOKT = SINGLE SOCKET  
NONE = NONE OF ABOVE

The unit will accept welding time in seconds and minutes according to ISO 13950. Values between 1-899 will be referred to seconds and values between 901-999 will be referred in minutes. See example below:

32 seconds will entered as 032 or 32.  
320 seconds will entered as 320.  
32 minutes will entered as 932.

KEY\_MENU will quit to Menu 1 screen.  
KEY\_START will proceed to welding process.

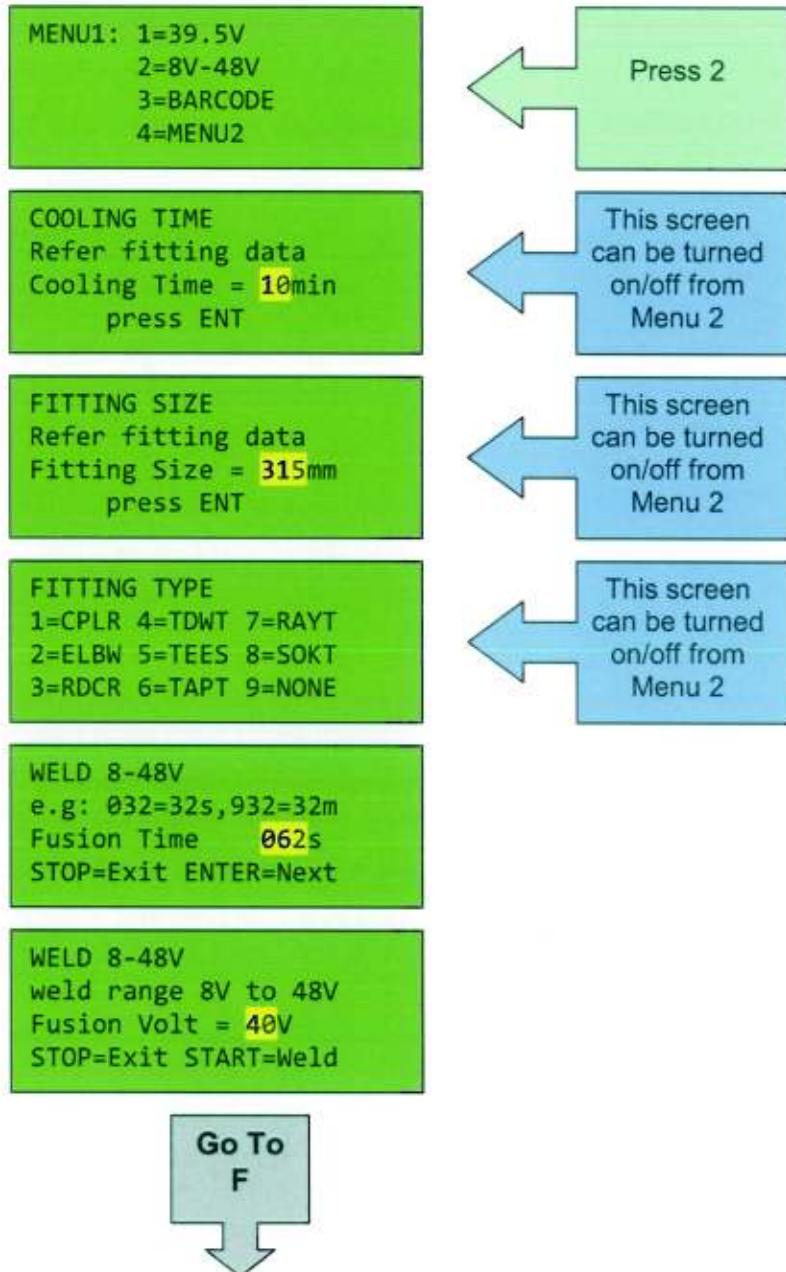

WELD 8-48V:

The following screens can be turned ON/OFF from Menu 2 (refer to Menu 2 section for details):

- COOLING TIME – enter required cooling time as specified in the fitting's data. Unit will go into countdown mode after a weld for the duration of cooling time entered. This information will be displayed in data retrieval.

## **NEXUS 500 Series Electrofusion Controller**

---

- FITTING SIZE – this information is stored for data retrieval purpose only.
- FITTING TYPE – this information is stored for data retrieval purpose only.  
Refer below for more details on abbreviations.

CPLR = COUPLER  
ELBW = ELBOW  
RDCR = REDUCER  
TDWT = TDW TAPPING TEE  
TEES = TEES  
TAPT = TAPPING TEE  
RAYT = RAYTRANS  
SOKT = SINGLE SOCKET  
NONE = NONE OF ABOVE

The unit will accept welding time in seconds and minutes according to ISO 13950. Values between 1-899 will be referred to seconds and values between 901-999 will be referred in minutes. See example below:

32 seconds will entered as 032 or 32.  
320 seconds will entered as 320.  
32 minutes will entered as 932.

KEY\_MENU will quit to Menu 1 screen.

KEY\_ENTER will proceed to next screen to enter welding voltage.

The welding voltage accepted in range 8V to 48V RMS value.

KEY\_MENU will quit to Menu 1 screen.

KEY\_START will proceed to welding process.



MENU1: 1=39.5V  
2=8V-48V  
3=BARCODE  
4=MENU2

Press 3

This Feature not supported in model NEX500-MI/DR Please contact MSA

Barcode feature not supported in your model

WELD BARCODE  
Barcode Input Method  
1=Use Scanner  
2=Type Manually

Press 1 or 2

Scan Fitting Fusion

Use scanner to scan fitting barcode 24-digits

Code:\*\*\*\*\*  
\*\*\*\*\*  
Press ENTER  
Rgt Lft Up Dwn, STOP

Enter fitting barcode 24-digits manually

Details +020.6°C  
COUPLER d250mm  
00.70Ω 40.0V 600s  
STOP=Exit START=Weld



**BARCODE:**

This welding feature is not supported in models MI and DR. Error screen will be displayed as shown above if tried to use Barcode feature.

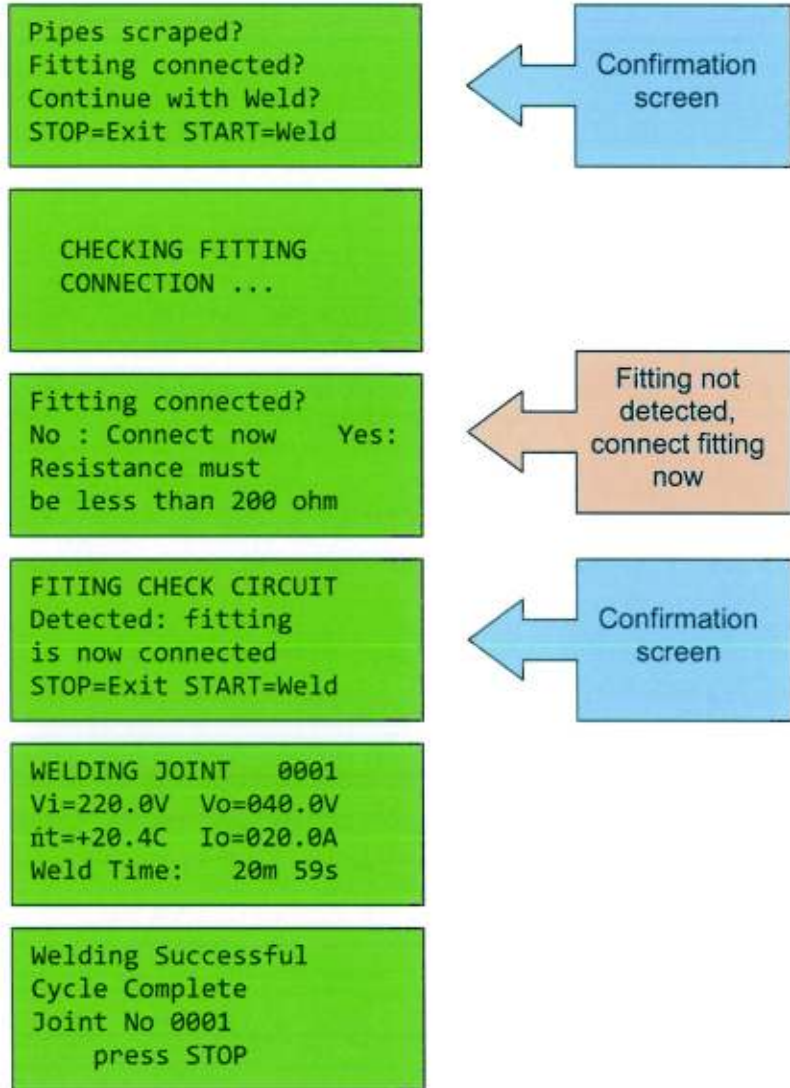

**WELDING PROCESS:**

If memory is full, welding may not be stored or process denied depending on systems settings from Menu 2.

Refer to "Additional Screens" section for more details on error screens.



MENU2: 1=Set-Time  
2=SysSetup  
3=ViewInfo  
4=Download

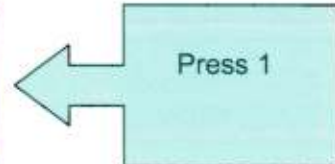

SETUP - TIME (24hr)  
HOUR:MINUTE  
hh:mm  
press ENTER

Set-Time:

Enter time in 24hr format.

E.g. 8.00AM = 08:00

8.00PM = 20:00

Press ENTER button to accept.



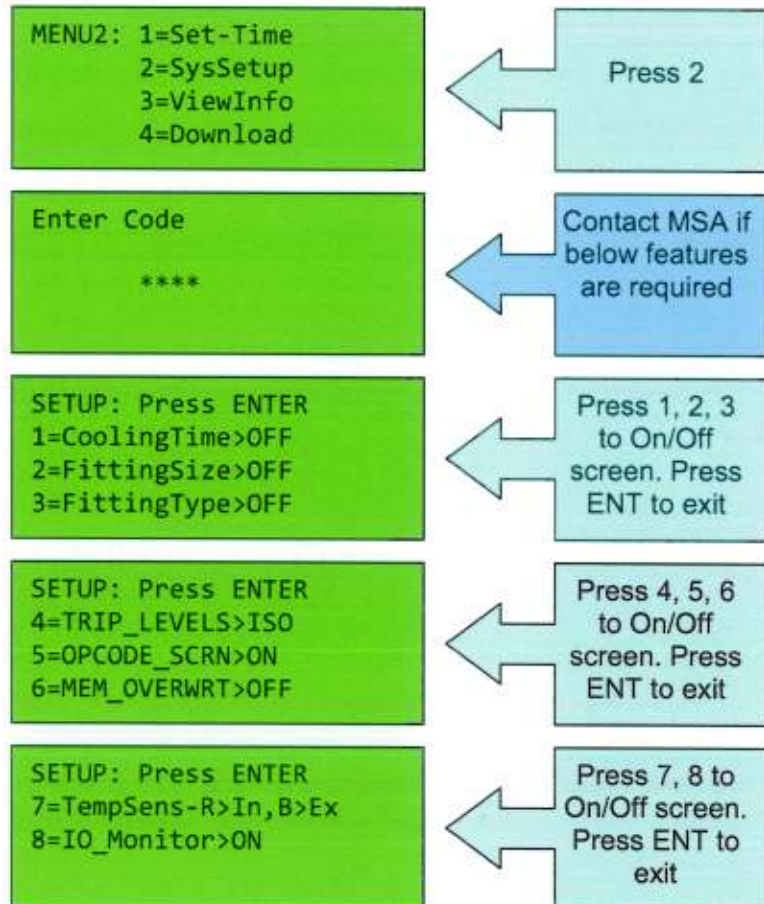

System Setup:

Certain features can be enabled or disabled with this System setup menu. Following items described below:

1. Cooling Time – if enabled, will prompt extra screen during welding procedure to input fitting's cooling time. This cooling time information will be saved for data retrieval and also will put unit in countdown mode after the welding is completed.
2. Fitting Size – if enabled, will prompt for extra screen during welding procedure to input fitting's size. This information is saved for data retrieval purpose only.
3. Fitting Type – if enabled, will prompt for extra screen during welding procedure to input fitting's type. This information is saved for data retrieval purpose only.
4. Trip Levels – for MSA internal use only, please **DO NOT** change this value.

## **NEXUS 500 Series Electrofusion Controller**

---

5. Operator Code – if enabled, will prompt for extra screen during start-up to input operator's name, code, ID etc. This 6-digit alphanumeric information is saved for data retrieval purpose only.
6. Memory Overwrite – if enabled, will automatically erase and overwrite old welding information when memory is full. If disabled, it will not allow welding to perform when memory is full.
7. Temperature Sensors – for MSA internal use only, please **DO NOT** change this value.
8. IO Monitor – for MSA internal use only, please **DO NOT** change this value.

Default settings are:

1. CoolingTime = OFF
2. FittingSize = OFF
3. FittingType = OFF
4. Trip\_Level = ISO
5. OPCODE\_SCRN = OFF
6. MEM\_OVERWRT = ON
7. TempSens-R=In, B=Ex
8. IO\_Monitor = ON

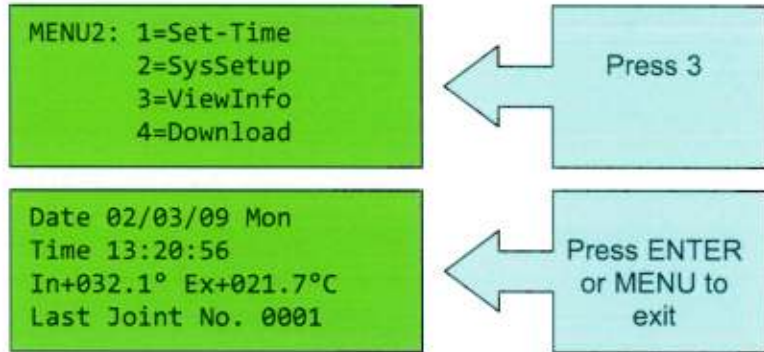

View Information:

This menu provides the following information (you can not edit from this menu):

- **Date:** 02/02/09 (in format dd/mm/yy)
- **Day:** Mon (i.e. Monday)
- **Time:** 13:20:56 (24hr format hh:mm:ss)
- **Internal Temperature:** +32.1°C (inside unit temperature)
- **External Temperature:** +21.7°C (ambient temperature)
- **Last Joint Number:** 0001 (Number of welds done by the unit)

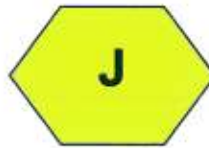

```
MENU2: 1=Set-Time  
        2=SysSetup  
        3=ViewInfo  
        4=Download
```

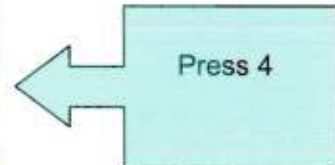

```
DATA DOWNLOAD:  
Settings:19200,N,8,1  
Last :    123 Joints  
STOP=Exit START=Print
```

Download:

This menu lets you download welding information to PC. Your computer settings for serial COM port should be:

- **Baud:** 19200
- **Parity:** None
- **Data:** 8 bits
- **Stop:** 1 bit

Enter number of joints to print, e.g. 123 will print the last 123 joints from total number of joints the unit has done.

Press KEY\_STOP to exit.  
Press KEY\_START to print.

## 8.0 Additional Screens

<p>Please wait... ECU in cooling mode Time min sec Remaining 12 36</p>		<p>The unit is in cooling mode - countdowns cooling time after a weld. Switching unit On/Off will remove this screen.</p>
<p>MEMORY FULL Joint 1234(12/05/06) Joint 5678(12/06/06) Delete? 1=Yes   2=No</p>		<p>This screen is displayed when memory is full. Press 1 will delete oldest memory section after a confirmation screen. Press 2 will exit.</p>
<p>Unit Requires Calibration Please contact MSA TEL:+44(0)1162608866</p>		<p>This is ONLY a reminder screen that unit requires calibration every 12 months according to ISO/ECE standards. It does NOT affect the performance of a weld.</p>
<p>Battery Low! replace with CR1225 and contact MSA for new RTC code</p>		<p>This screen is displayed when real-time clock (RTC) battery needs replacing. Obtain new RTC code from MSA for clock reset.</p>
<p>BadgeNo :MSA123 Skill :Automatic Expiry :Jun 2009 Company :MS</p>		<p>Nexus model "TO" uses operator badge to enable welding process depending on user's skill defined in 30-digit barcode. This is for traceability purpose. Contact MSA for more details.</p>
<p>Error! Invalid Badge The operator badge is expired,can not proceed further</p>		<p>This error screen is related to Nexus model "TO" when the operator badge is expired/invalid. Contact MSA for more details.</p>
<p>Enter Code  ****</p>		<p>This screen is displayed when unit is asking for password.</p>
<p>Scan Pipe1 Tracecode  STOP=Skip</p>		<p>Nexus model "TR/TO" requires scans of Pipe1 and Pipe 2 barcodes for traceability. This is a 40-digit barcode. Contact MSA for more details. Press CLR to skip.</p>
<p>Scan Fitting Trace  STOP=Skip</p>		<p>Nexus model "TR/TO" requires scans of Fitting's trace barcodes for traceability. This is a 26-digit barcode. Contact MSA for more details. Press CLR to skip.</p>

<p>Warning! Unit is very hot allow it to cool Please weld later</p>		<p>Thermal switch inside the unit tripped. Please allow unit to cool down for switch to reset. This switch protects unit from overheating and causing damage.</p>
<p>invalid code Please contact MSA</p>		<p>Certain setup codes obtained from MSA checks for validity against serial number and date. Please obtain another code from MSA and use it within seven days validity period.</p>
<p>This Feature not supported in model NEX500-MI/DR Please contact MSA</p>		<p>Nexus models "MI/DR" does not support use of barcode features. Contact MSA if such features are required.</p>
<p>MEMORY FULL !WILL NOT SAVE WELD! CLR=Clear Memory ENT=Continue Weld</p>		<p>This screen is displayed when MEM_OVERWRT=OFF in Systems Setup from Menu 2. Weld is possible but will not save joint information.</p>
<p>Welding Error Cycle Reset Joint No 0001 press STOP</p>		<p>User aborted welding cycle by pressing Stop key.</p>
<p>Welding Error Output Voltage Fault Joint No 0001 press STOP</p>		<p>Incorrect output voltage. Check input voltage is within spec during weld. Check correct pin 4.0mm or 4.7mm is used in fitting. Try another fitting. Contact MSA if problem still persists.</p>
<p>Welding Error Fitting Shorted Joint No 0001 press STOP</p>		<p>Check input voltage is within spec during weld. Try another fitting. Contact MSA if problem still persists.</p>
<p>Welding Error Fitting Opened Joint No 0001 press STOP</p>		<p>Check input voltage is within spec during weld. Check correct pin 4.0mm or 4.7mm is used in fitting. Try another fitting. Check cables not damaged. Contact MSA if problem still persists.</p>
<p>Welding Error Input Voltage Fault Joint No 0001 press STOP</p>		<p>Check input voltage is within spec during weld. Contact MSA if problem still persists.</p>

## NEXUS 500 Series Electrofusion Controller

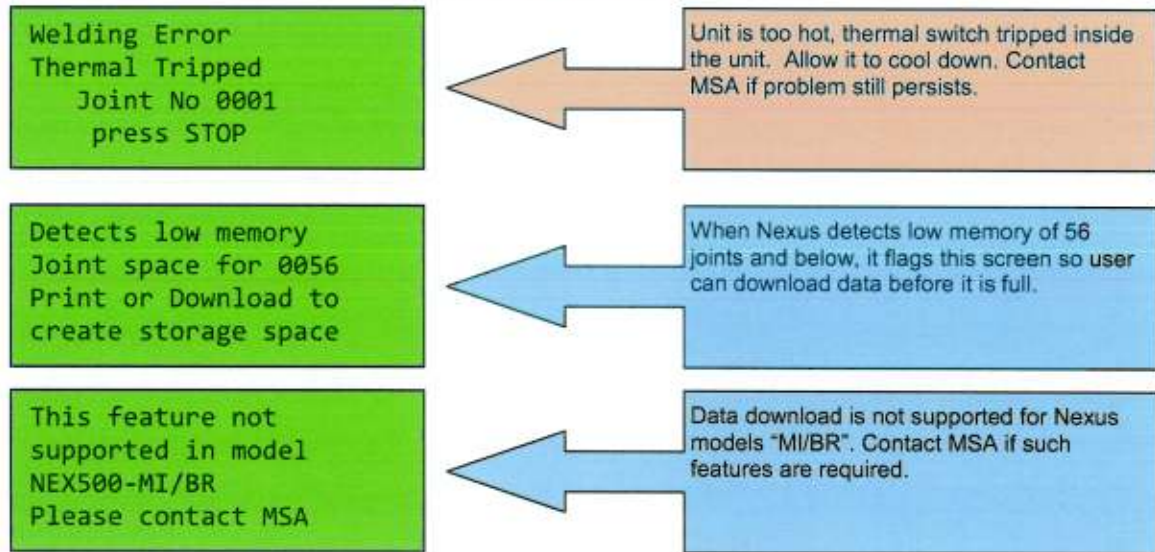

## 9.0 Maintenance

### 9.1 Spare Parts

Spare parts for the unit include:

Part Number	Description	Quantity
Acc. to Model	Manual	1
6610-0064	IP68 Dust Cap for Barcode Scanner Cable Plug	1
6610-0063	IP68 Dust Cap for connection socket on Remote Keypad for the Barcode Scanner	1
FL2001-4.0-4.7A	Terminal Pin Adaptor 4.0 - 4.7mm	1 pair
FL2001-4.7-4.0A	Terminal Pin Adaptor 4.7 - 4.0mm	1 pair

### 9.2 Testing

Functional tests (simulating Open and Short Circuit conditions) are possible with the use of a load bank (contact MSA for further information).

#### **PAT Testing:**

The Health and Safety Executive (HSE) have found that a quarter of reportable electrical accidents are due to faulty portable appliances. There is a need to inspect and test such appliances, with a view to reduce the number of accidents. The NEXUS 500-LT Series is classified as CLASS 2, therefore the only test that can be performed on the unit is the Insulation Test.

**WARNING! DO NOT CARRY OUT FLASH TEST.**

### 9.3 Service

It is recommended that your unit is calibrated at least once every year (once every six months, if used for Gas installations).

MSA provide a full after-sales service for repair and maintenance of NEXUS Electrofusion Controllers. Equipment can be re-programmed for new working practices or upgraded to include use of the latest automatic control systems.

Equipment to be returned to MSA should be clearly marked with suspected fault and/or service required, as well as contact name, address, telephone and fax numbers, and details of return address. All equipment should be returned to our Sales and Service Department at the address below.

**MSA ENGINEERING SYSTEMS LIMITED**  
 3 Assured Drive, Thurmaston, Leicester, LE4 8BB, United Kingdom  
 Phone: +44 (0)116 260 8866 Fax: +44 (0)11 260 8861  
 Email: sales@msa-engineering.co.uk Web: [www.msa-engineering.co.uk](http://www.msa-engineering.co.uk)



## 10.0 Appendix One – Models and Accessories

### 10.1 NEXUS Models

Models	Operating Modes / Functions (110 or 220/240V Input)
NEX510-MI	Manual Input (39.5V fixed & 8 to 48V variable)
NEX510-BR	Manual Input (39.5V fixed & 8 to 48V variable) Barcode Recognition (ISO TR 13950) Inc. CCD Scanner (NEX7100-01-000)
NEX510-DR	Manual Input (39.5V fixed & 8 to 48V variable) Data Retrieval (weld information)
NEX510-BD	Manual Input (39.5V fixed & 8 to 48V variable) Barcode Recognition (ISO TR 13950) Data Retrieval (weld information) Inc. CCD Scanner (NEX7100-01-000)
NEX520-TR	Manual Input (39.5V fixed & 8 to 48V variable) Barcode Recognition (ISO TR 13950) Traceability Barcode Recognition Data Retrieval (traceability & weld information) Inc. CCD Scanner (NEX7100-01-000)
NEX520-TO	Manual Input (39.5V fixed & 8 to 48V variable) Barcode Recognition (ISO TR 13950) Traceability Barcode Recognition Operator Badge/Barcode Recognition Data Retrieval (traceability & weld information) Inc. CCD Scanner (NEX7100-01-000)

\* Pre-fix is NCU for Nexus Combi-Unit

### 10.2 Accessories

Part No.	Description
NEX7100*	CCD Bar Code Scanner (Gun Type)
DataSoft 3.*	PC Interface Software & Adaptor Lead (Data Retrieval – traceability/weld information)

Please enquire directly to MSA for the following items:

- Transport cases
- Load banks and equipment for testing the working status of ECU's
- Self-calibration check equipment/procedure using barcode scanner.



MSA ENGINEERING SYSTEMS LIMITED

**NEXUS 500 Series**  
**Electrofusion**  
**COMBI-UNIT**  
***Instructions***



---

The information contained in this manual is consistent with MSA's knowledge at the time of publication. Any unauthorised usage of this equipment other than that to which it was designed will negate any liability unless specifically authorised in writing by MSA Engineering Systems Limited. This does not affect statutory rights.

## Contents

	<b>Page No.</b>
<b>1.0 Equipment List</b>	<b>2</b>
<b>2.0 Warranty</b>	<b>2</b>
<b>3.0 Generator Safety and Care</b>	<b>2</b>
3.1 General Safety	2
3.2 Generator Safety	2
<b>4.0 Specifications</b>	<b>3</b>
4.1 Generator Specification	3
4.2 Alternator Specification	3
4.3 COMBI-UNIT Specification	3
<b>5.0 Operation</b>	<b>4</b>
5.1 Description	4
5.2 NEXUS COMBI-UNIT Overview	5
5.3 Starting the Generator	6
5.4 Stopping the Generator in NORMAL and EMERGENCY	7
<b>6.0 Service</b>	<b>8</b>

**Please refer to the NEXUS 500 Series Electrofusion Control Unit Operating Manual for full instructions on using the NEXUS ECU. This document contains additional information related to the generator.**

### 1.0 Equipment List

Equipment included in the basic package includes:

- MSA NEXUS 500 Series Electrofusion COMBI-UNIT
- Remote Keypad for the COMBI-UNIT
- 4.0mm and 4.7mm Terminal Ends
- Nexus COMBI-UNIT instructions
- Nexus 500 Series Operating Manual
- Honda GX270 Owner's Manual
- Calibration Certificate

For a list of available accessories, see section NEXUS 500 Series Operating Manual

### 2.0 Warranty

MSA NEXUS Electrofusion COMBI-Units are guaranteed against faulty materials or workmanship for a period of 12 months from the date of purchase. Any units which fail under the warranty will be repaired or replaced free of charge at the discretion of MSA Engineering Systems Limited.

### 3.0 Generator Safety and Care

#### 3.1 General Safety

This equipment is heavy (100kg), never attempt to lift it on your own, always get help.

All leads should be fully unwound, loosely coiled and placed in the provided trays when storing or transporting the unit. Never run them through water, over sharp edges or where they could trip someone.

#### 3.2 Generator Safety

**Petrol is extremely flammable and explosive under certain conditions.**

**Exhaust fumes contain carbon monoxide – inhalation of such fumes can kill.**

- Always refuel in an area which is adequately ventilated.
- Do not smoke when refuelling – Keep all inflammable objects clear of the generator.
- Avoid overfilling.
- Be careful not to spill fuel over the generator, clean up spillages.
- Move the equipment away from the area where fuel has been spilt.
- Do not refuel when the engine is running.
- Do not remove covers and attempt to work on the generator while the engine is running, and do not use the equipment with any loose components or guards.
- Do not run the engine in an area which has a hazardous or explosive atmosphere.
- Always ensure the fuel cap is secure after refuelling.
- Keep the engine at least 3m or more away from any other equipment or building.
- Take care not to get fuel on your clothing. If this happens change your clothing immediately. Do not start the engine when clothing has been contaminated with fuel.

## NEXUS 500 Series Electrofusion COMBI-Unit

- Use only approved type containers for fuel. Do not stand them out in strong sunlight, keep them in the shade.
- Always ensure there is a suitable fire extinguisher available and within easy reach.
- Do not leave the engine running unattended. Always stop it before leaving the area.
- Wear appropriate protective clothing, i.e. safety helmet, safety goggles, ear defenders, safety shoes.
- Should a fuel or oil leak develop at any time, switch off power and engine immediately.
- Place the unit on a firm, level, dry base and secure it to prevent accidental movement. The area should also be cleared of any combustible materials.
- Remember that electricity is dangerous, so treat the power produced by the generator the same as you would with mains electricity.
- Protect the unit against rain. Do not operate in standing water.
- Operate in a well ventilated and in unconfined area - exhaust fumes can kill.
- Should the unit fail to operate contact the manufacturer or the branch from which it was hired.

## 4.0 Specifications

### 4.1 Generator Specification

Model:	Tin 12 cert. 3.5KW (4.4KVA) (small ECE3 SET)
Engine Type:	HONDA GX270
Maximum Output:	9.0 HP/3,600 rpm.
Maximum Torque:	1.95kg-m/2,500 rpm.
Fuel Type:	Unleaded or low-leaded.
Fuel Consumption:	230 g/PSh.
Fuel Tank Capacity:	5.9L (1.56 US gal, 1.30 Imp gal).
Engine OIL Type:	SG, SF rated engine oil.
Engine OIL Capacity:	1.10L (1.16 US qt, 0.97 Imp qt).
Spark Plug (Recommended):	BPR6ES (NGK) or W20EPR-U (DENSO).

### 4.2 Alternator Specification

Model:	MECC ALTE S16W-105/B
Type:	1 Phase, 50Hz – 3000 rpm.
Power:	4.1KVA.
Output Voltage:	110V ac.

### 4.3 COMBI-UNIT Specification

Frame Length:	900mm (plus handle)
Frame Width:	480mm (plus wheels)
Frame Height:	710mm (plus handle)
Approx Overall Dimensions:	1050mm L x 615mm W x 730mm H
Overall Weight:	100 KG

## **5.0 Operation**

### **5.1 Description**

The NEXUS COMBI-UNIT is a complete portable electrofusion system, which provides a safe and reliable method of jointing polyethylene pipelines with a variety of couplings. The built in NEXUS ECU has been designed to be extremely versatile, able to accommodate all 8 – 48 Volt fittings currently manufactured within the specifications of the device.

The operation of the NEXUS COMBI-Unit has been designed for ease of use to be driven by on-screen prompts, guiding the user through their choice of manual (either at a set 39.5V or varying from 8 to 48V) or auto (with barcode recognition) weld modes.

On-screen instructions are displayed throughout the operation of the unit allowing easier navigation through the functions and operations.

To switch the NEXUS Unit off at any time, simply press the Emergency STOP button (red button) at the top of the Remote Keypad.

Ensure that the Output Leads are always kept clean to ensure good contact with the fitting. When changing the Terminal Ends (4.0mm and 4.7mm available) only tighten them by hand to finger-tight level.

See the NEXUS 500 Series Electrofusion Control Unit manual for full instructions on using the ECU.

**5.2 NEXUS COMBI-UNIT Overview**

REF	DESCRIPTION	MSA PART NO.
1	NCU 500 SERIES COMBI-UNIT	NCU5**-** (*)
2	NEXUS ECU	
3	6M OUTPUT LEADS	FL2000-02-000
4	HHU LEAD	NEX6506-01-000
5	REMOTE KEYPAD (HHU)	NEX6502-01-000
6	CCD BARCODE SCANNER (GUN)	NEX7100-01-000
7	TERMINAL END 4.0MM	FL2000-01-003
8	TERMINAL END 4.7MM	FL2000-01-004

(\*) - SUBJECT TO MODEL VARIANT

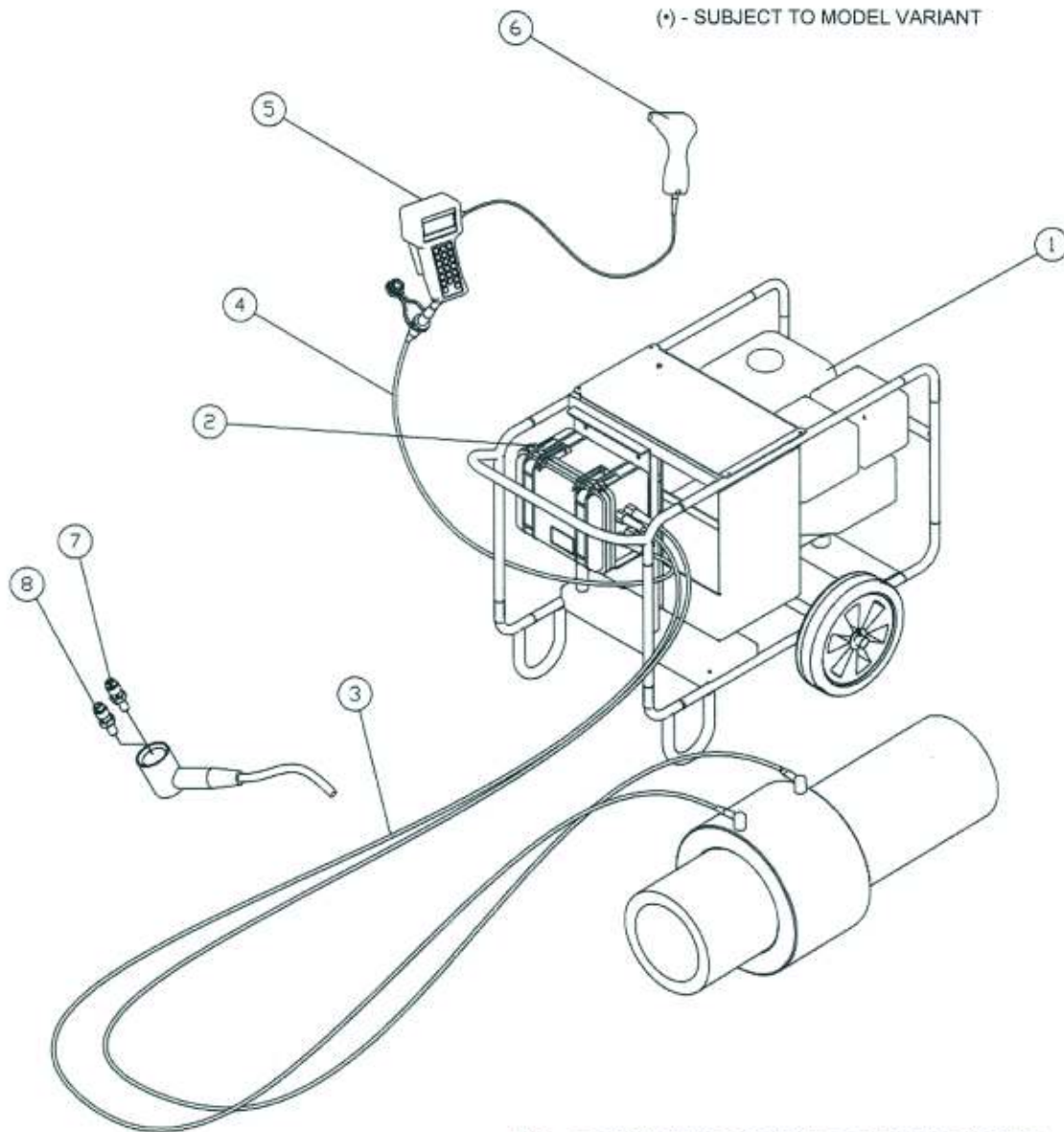

**N.B: COMBI-UNIT SHOULD BE LIFTED USING GENERATOR FRAME ONLY**

### 5.3 Starting the Generator

Turn the fuel valve to the ON position.

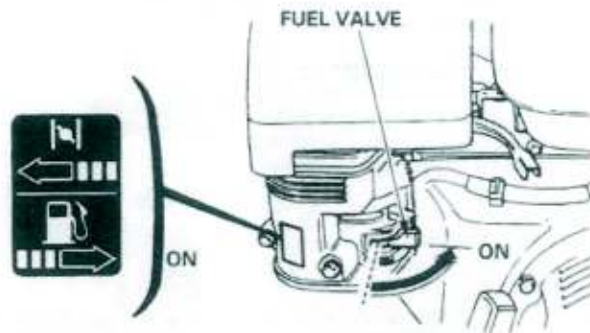

Move the choke lever to the CLOSE position.

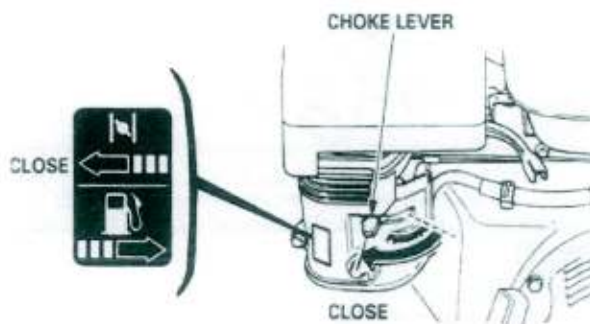

Turn the engine switch to the ON position.

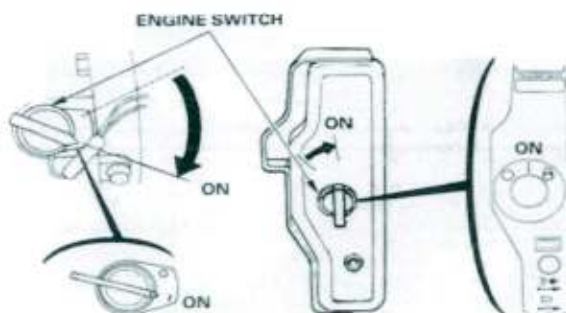

Pull the starter grip lightly until resistance is felt, then pull briskly.





As the engine warms up, gradually move the choke lever to the OPEN position.

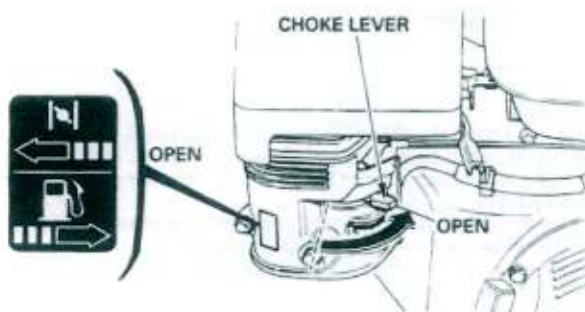

#### **5.4 Stopping the Generator in NORMAL and EMERGENCY**

To stop the engine in an emergency, turn the engine switch to the OFF position.

Under normal conditions, use the following procedure:

Turn the engine switch to the OFF position.

Turn the fuel valve to the OFF position.

**For detailed information refer to section 4 through to 6 of the supplied HONDA GX270 owner's manual.**

## **6.0 Service**

It is recommended that your unit is calibrated at least once every year (once every six months, if used for Gas installations).

MSA provide a full after-sales service for repair and maintenance of NEXUS Electrofusion Controllers. Equipment can be re-programmed for new working practices or upgraded to include use of the latest automatic control systems.

Equipment to be returned to MSA should be clearly marked with suspected fault and/or service required, as well as contact name, address, telephone and fax numbers, and details of return address. All equipment should be returned to our Sales and Service Department at the address below.

**MSA ENGINEERING SYSTEMS LIMITED**  
3 Assured Drive, Thurmaston, Leicester, LE4 8BB, United Kingdom  
Phone: +44 (0)116 260 8866 Fax: +44 (0)11 260 8861  
Email: [sales@msa-engineering.co.uk](mailto:sales@msa-engineering.co.uk) Web: [www.msa-engineering.co.uk](http://www.msa-engineering.co.uk)